



St.GERMAIN
a place like no other



LOT 1421 4 🚗 2 🏠 2 🚗

LAND SIZE: 400m2 FRONTAGE: 12.5m

ELLIOT 20 – \$554,800

- > Site Work Allowance
- > Ochre Facade
- > Stainless Steel Kitchen Appliances
- > Stainless Steel 600mm Baumatic Dishwasher
- > Timber Laminate Flooring or Floor Tiles to Family Room
- > Recycled Water & NBN Connections
- > **Your Choice from:- Kitchen Upgrade, Bathroom Upgrade, Ceilings, Electrical, Concrete or Evaporative Cooling Packages**

YARRABANK
individual homes

Registered Company: Pierce Gould Pty Ltd – CDB-U 49788

Call George Racz on **0419 528 139**
or e george@yarrabankhomes.com.au
to discuss your new home at St Germain.
stgermain.net.au

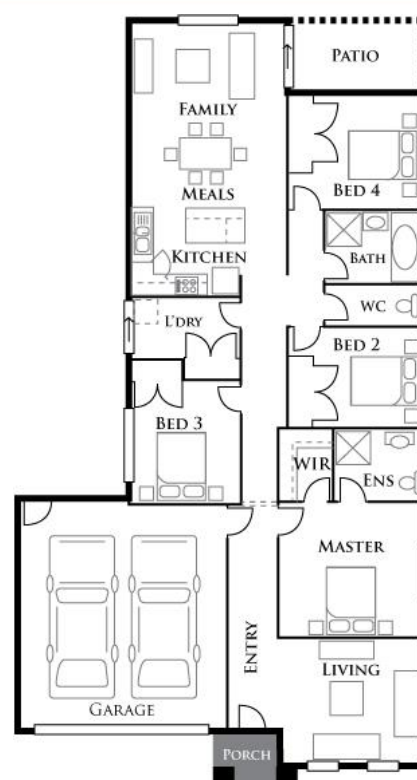

This floorplan is subject to obtaining the following information, Final Working Drawings, Soil Report, Energy rating Report, Engineering Plans and Developer Approval (if required). NOTE: Sewer, Water, Gas, Stormwater and underground electrical pit to be made available by the client if not already available. This proposal includes the Builders Standard Specifications which are included herein, all pricing and items are subject to availability and may be modified within reason by the Builder with notice given to the building owner. Images are for illustration purposes only and may not represent the outcome for your new home exactly but are an indication based on what has been built by the builder previously.