



**St.GERMAIN**  
a place like no other



**LOT 1207** 4 🚗 2 🏠 2 🚗

LAND SIZE: 336 SQM

FRONTAGE: 10.5M

# Ripponlea 215

## \$552,570\*

- > Fixed Site Costs
- > Council & Developer Requirements
- > 30 Year Structural Guarantee
- > 12 Month Price Freeze
- > Condor Façade Included
- > Multiple Floorplans and Façade Options Available
- > Style Your Home With Expert Interior Designers

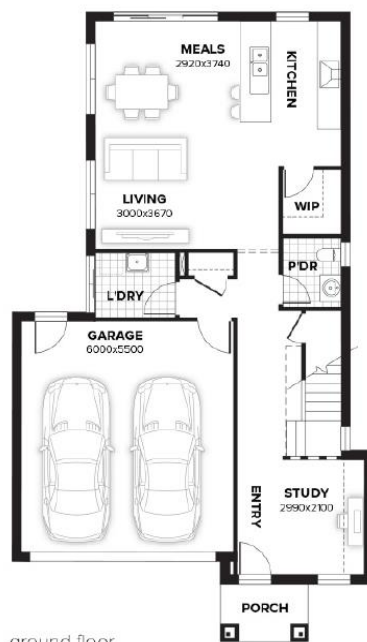

ground floor



first floor

**Call Daniel Lee on 04280 588 588** to discuss your new home at St Germain.  
[stgermain.net.au](http://stgermain.net.au)

\*Burbank reserve the right to alter any price without notice. All drawing and plans are subject to developers and/or authority approval and may vary depending on the outcome of their decision. In the event where amendments are required the drawings, plans and the advertised price of the proposed dwelling will vary accordingly. The purchaser acknowledges that the advertised price may vary due to factors outside the control of the builder. These photos and images are for illustrative purposes only and may depict upgrade options available from Burbank at additional charges such as lighting, window furnishings, landscaping, driveway, paving and timber windows. The price also excludes features not supplied by Burbank such as gardens, fencing and decking. Any alterations and upgrades may incur additional costs. The price does not include stamp duty, legal fees or other costs incurred with the purchase of the land. Please consult a Burbank sales representative for further information and detailed pricing. All designs are the property of Burbank and must not be used, reproduced, copied or varied, wholly or in part without written permission from an authorised Burbank representative. Copyright. Burbank Australia Pty Ltd. ABN 91 007 099 872. Builders Registration number DB-U3333. Subject to Burbank's preferred sitting.